



MERRIGAN & LeFEBVRE Realty, Inc.

commercial • industrial • land • intermodal

Merrigan & LeFebvre Realty Inc. • 560 Halfway House Road • Windsor Locks, CT 06096

Phone: (860) 623-2389 • Fax (860) 623-5109 • www.merriganlefebvre.com

LAND FOR LEASE

15, 17 & 19 Northgate Drive, Windsor Locks, CT 06096 • Hartford County

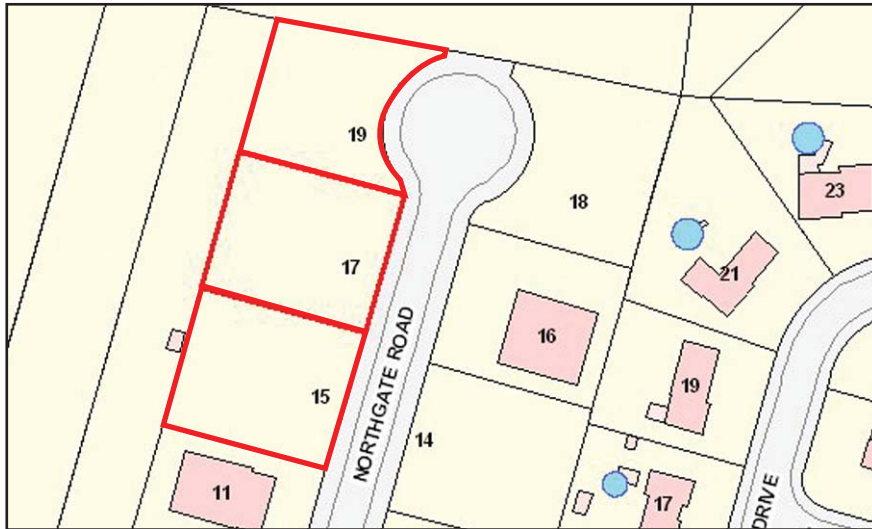

■ Property Details

Site

Property Type: Land
Site Area: 1.26 Acres
Zone: Industrial

Utilities

Sewer: Public Available
Water: Public Available
Gas: Available
Electricity: Available

Price

Price: \$1800 / Month - Land Lease

■ Property Description

1.26 Acres at Numbers 15, 17 & 19 Northgate Drive. \$1800/month. All utilities available.

■ For More Information Contact

Dan Carstens
Office (860) 623-2389 / Cell (860) 306-3214
dcarstens@merriganlefebvre.com